

INSPIRE 2

GPS Module for the Remote Controller

User Guide

V1.2 2017.04

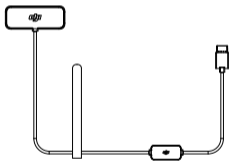

Disclaimer

Congratulations on purchasing your new DJI™ product. The information in this document affects your safety and your legal rights and responsibilities. Read this entire document carefully to ensure proper configuration before use. Failure to read and follow instructions and warnings in this document may result in serious injury to yourself or others, damage to your DJI product, or damage to other objects in the vicinity. This document and all other collateral documents are subject to change at the sole discretion of DJI.

By using this product, you hereby signify that you have read this disclaimer and warning carefully and that you understand and agree to abide by the terms and conditions herein. You agree that you are solely responsible for your own conduct while using this product, and for any consequences thereof.

You agree to use this product only for purposes that are proper and in accordance with all applicable laws, rules, and regulations, and all terms, precautions, practices, policies and guidelines DJI has made and may make available.

DJI accepts no liability for damage, injury or any legal responsibility incurred directly or indirectly from the use of this product. The user shall observe safe and lawful practices including, but not limited to, those set forth in this document.

Notwithstanding above, your statutory rights under applicable national legislation are not affected by this disclaimer.

DJI is a trademark of SZ DJI TECHNOLOGY CO., LTD. (abbreviated as "DJI") and its affiliated companies. Names of products, brands, etc., appearing in this document are trademarks or registered trademarks of their respective owner companies. This product and document are copyrighted by DJI with all rights reserved. No part of this product or document shall be reproduced in any form without prior written consent of or authorization from DJI.

Warnings

1. DO NOT place the INSPIRE™ 2 GPS Module for the Remote Controller next to sources of strong magnetic or electric fields.
2. Keep the Inspire 2 GPS Module for the Remote Controller away from direct sunlight and other heat sources.
3. Liquid spills may cause permanent damage to the Inspire 2 GPS Module for the Remote Controller.
4. DO NOT apply external pressure to the Inspire 2 GPS Module for the Remote Controller.

Introduction

If the Inspire 2 GPS Module for Remote Controller is used, when Follow Me is activated, the aircraft will automatically follow more precisely. The real-time location of the remote controller will also be recorded as the Home Point even when the controller is moving, helping ensure a safe return of the aircraft.

Overview

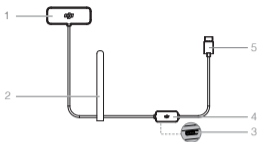

1. Master Part of the GPS Module
2. Velcro Strap
3. CAN Bus Port

4. CAN Hub
5. Cable End

Installation

1. Stick the provided Velcro tape on the back of the Master part of the GPS module, the Can Hub, the remote controller and the top of the mobile device holder respectively.

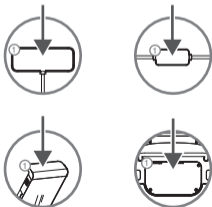

2. Mount the master part of the GPS Module on the top of the mobile device holder with the help of the already stuck-on Velcro. The side marked with the DJI logo should face out when the master part is properly mounted.

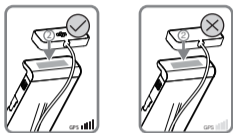

Please stick the Velcro tape on the side of the master part and then attach it to the top of the mobile device holder when the mobile device holder is pressed down, ensuring that the side marked with the DJI logo is always facing out when in use.



3. Fasten the cable and the mobile device holder, and prevent it from dangling with the Velcro strap. Ensure that the cable hangs down beneath the remote controller alongside one side of an antenna. DO NOT let the cable pass through the middle of the antennas.



4. Stick the CAN hub on the bottom of the remote controller tightly as shown below.
5. Insert the cable end to the CAN Bus port on the remote controller.

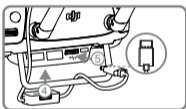

6. Installation is complete.





- DO NOT let the cable pass through the middle of the antennas, or it may negatively affect the signal.
- DO NOT cover the GPS Module with metal.
- Ensure the cable is inserted correctly or the CAN Bus port may be damaged.
- Always power off the remote controller when mounting the GPS Module.
- Press hard when mounting the Master part of the GPS module and the Can Hub, or the Velcro may not be able to tighten the GPS Module securely.



Other equipment can be connected to the CAN Bus port on the CAN hub, e.g. DJI Focus.

Specifications

Weight: 33.9 g

Satellite Positioning System: GPS / GLONASS

Max. Current: 125 mA

Max. Voltage: 5.3 V

This content is subject to change.

Download the latest version from
<http://www.dji.com/inspire-2>

INSPIRE is a trademark of DJI.

Copyright © 2016 DJI All Rights Reserved.

Compliance Information

FCC Compliance

This device complies with Part 15 of the FCC Rules. Operation is subject to the following two conditions: (1) This device may not cause harmful interference, and (2) This device must accept any interference received, including interference that may cause undesired operation.

Any changes or modifications not expressly approved by the party responsible for compliance could void the user's authority to operate the equipment.

EU Compliance Statement: SZ DJI TECHNOLOGY CO., LTD. hereby declares that this device is in compliance with the essential requirements and other relevant provisions of the EMC Directive.

A copy of the EU Declaration of Conformity is available online at HYPERLINK "<http://www.dji.com/euro-compliance>" www.dji.com/euro-compliance



EU contact address: DJI GmbH, Industrie Strasse.
12, 97618, Niederlauer, Germany

DJI Support

<http://www.dji.com/support>

If you have any questions about this document,
please contact DJI by sending a message to
DocSupport@dji.com.

Printed in China.